

# Hydraulic Toe Jacks

V / V-EX / G / U

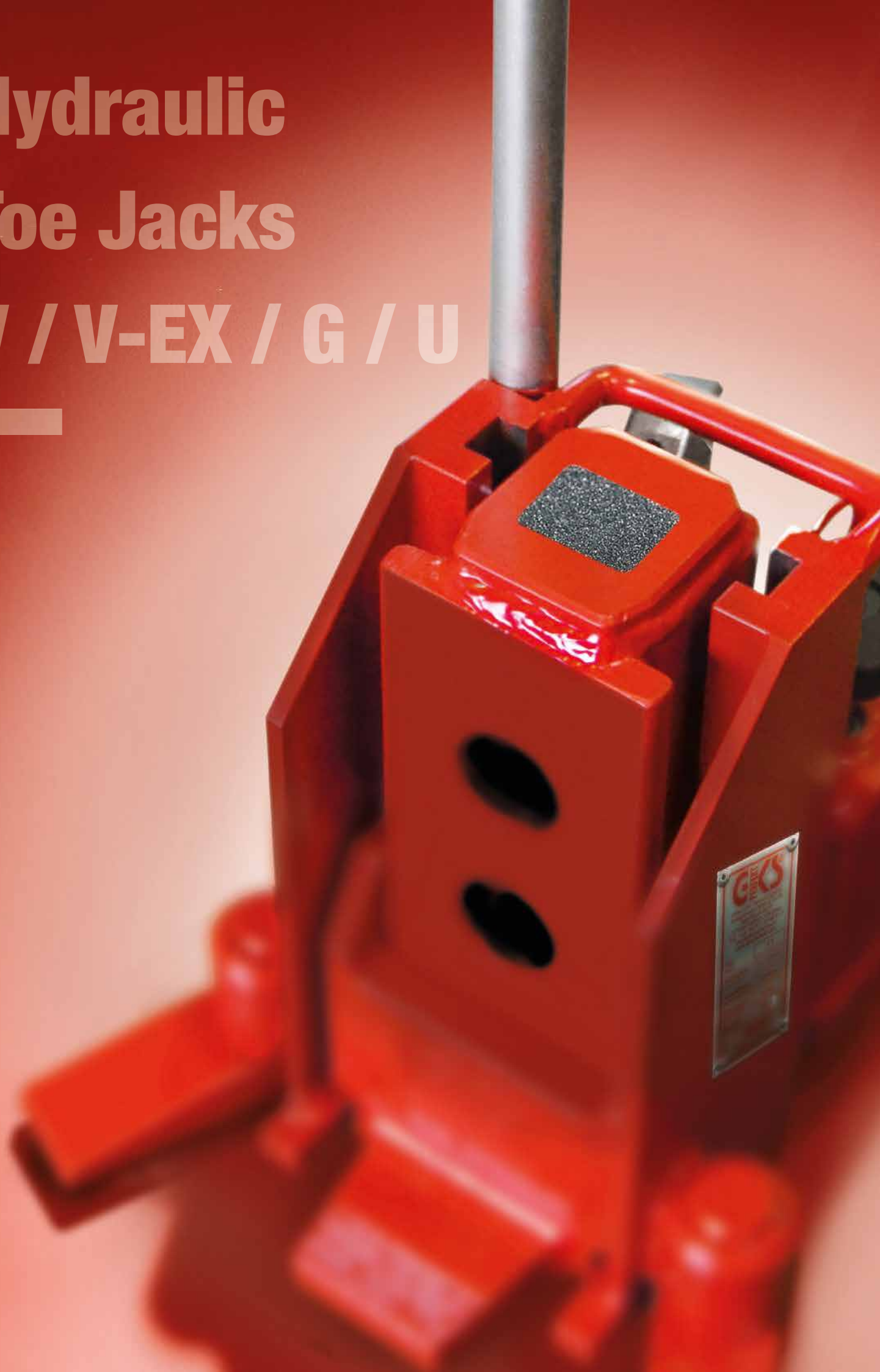

# Hydraulic Toe Jacks

## V / V-EX / G / U

GKS-PERFEKT hydraulic toe jacks meet the highest quality standards. For decades our equipment has been proven worldwide to be exceptionally robust and durable. Our jacks are 100% tested and approved before leaving the factory to assure proper functionality and appearance. The customer receives a ready to use, practical device for multi-purpose applications at any given site, such as the factory floor, the shop, outside or in production.

### FEATURES

- High-quality materials
- Precision guideways
- Our well-proven, die-forged and hight-adjustable safety toe with high safety margin
- Test mark BGV D8 (DE), ANSI/ASME (US)
- Modular design for easy repair/maintenance
- Lifetime technical support
- Especially low loading height, as low as 15 mm

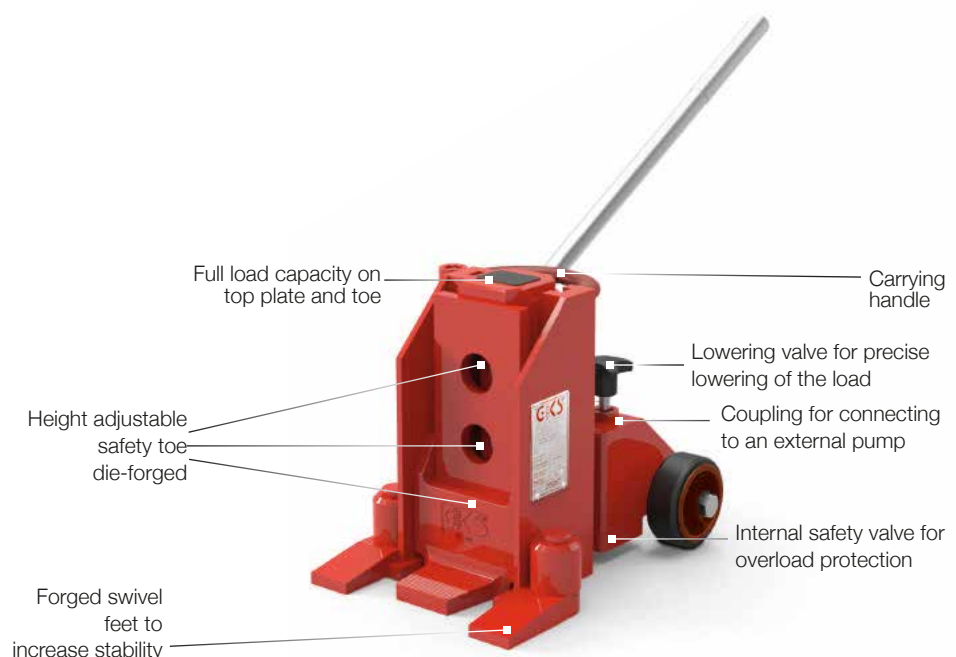



## Toe Jack V5 ►► For heavy loads up to 5 tons

### Features:

- Forged safety toe, made of high-strength, hardened and tempered high-quality steel
- Forging yields a very high safety margin (exceeds the EU Directive 2006/42/EC)
- A peg on the back secures correct insertion
- Using the hand pump PV with 2 jacks or electric pump PE with 4 jacks or Quadro synchronous lifting device can double/quadruple the load capacity.



### Technical data

#### V5

|   |                    |
|---|--------------------|
| Item number                             | 10181              |
| Full load capacity                      | 50 kN (5 t)        |
| Working pressure                        | 520 bar            |
| Minimum loading height using safety toe | 15 mm              |
| Lifting height                          | 140 mm             |
| Adjustable range of safety toe          | 3 x                |
| Loading height using top plate          | 252 mm             |
| Overall dimensions (L x W x H)          | 285 x 235 x 252 mm |
| Tare weight in kg with oil fill         | 21 kg              |

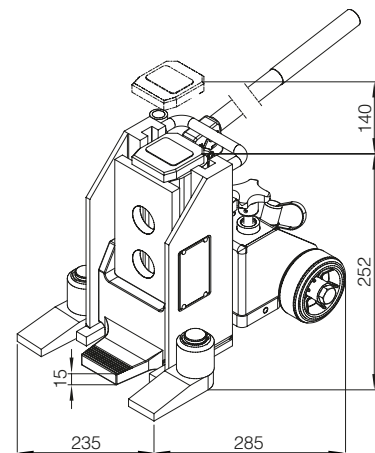



## Toe Jack V10 ►► For heavy loads up to 10 tons

### Features:

- Forged safety toe, made of high-strength, hardened and tempered steel
- Forging yields a very high safety margin (exceeds the EU Directive 2006/42/EC)
- A peg on the back secures correct insertion
- Using the hand pump PV with 2 jacks or electric pump PE with 4 jacks or Quadro synchronous lifting device can double/quadruple the load capacity.

### Technical data

#### V10

|   |                    |
|---|--------------------|
| Item number                             | 10182              |
| Full load capacity                      | 100 kN (10 t)      |
| Working pressure                        | 520 bar            |
| Minimum loading height using safety toe | 20 mm              |
| Lifting height                          | 160 mm             |
| Adjustable range of safety toe          | 4 x                |
| Loading height using top plate          | 310 mm             |
| Overall dimensions (L x W x H)          | 357 x 260 x 310 mm |
| Tare weight in kg with oil fill         | 32 kg              |

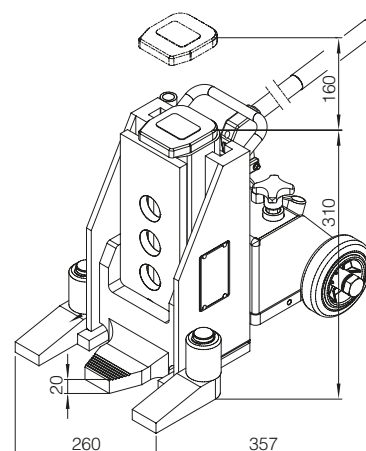

Contents

Hydraulic  
Toe Jacks

Pumps

Transport Trolleys

Rotating Trolleys

Transport Module  
ROBOT

Wheels

Special  
Transport Trolleys

Repair  
Services



## Toe Jack V15 ►► For heavy loads up to 15 tons

### Features:

- Forged safety toe, made of high-strength, hardened and tempered steel
- Forging yields a very high safety margin (exceeds the EU Directive 2006/42/EC)
- A peg on the back secures correct insertion
- Using the hand pump PV or electric pump PE with two or more jacks can double/quadruple the load capacity.



### Technical data

#### V15

|   |                    |
|---|--------------------|
| Item number                             | 10183              |
| Full load capacity                      | 150 kN (15 t)      |
| Working pressure                        | 520 bar            |
| Minimum loading height using safety toe | 25 mm              |
| Lifting height                          | 160 mm             |
| Adjustable range of safety toe          | 4 x                |
| Loading height using top plate          | 318 mm             |
| Overall dimensions (L x W x H)          | 403 x 320 x 318 mm |
| Tare weight in kg with oil fill         | 53 kg              |

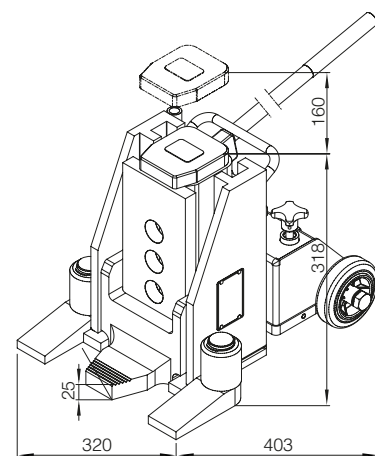





## Toe Jack V20 ►► For heavy loads up to 20 tons

### Features:

- Easily roll our toe jacks by tilting the units onto their transport wheels, saving your strength and back
- Quick lift with triple the travel per lift

### Technical data

#### V20

|   |                    |
|---|--------------------|
| Item number                             | 10184              |
| Full load capacity                      | 200 kN (20 t)      |
| Working pressure                        | 520 bar            |
| Minimum loading height using safety toe | 30 mm              |
| Lifting height                          | 160 mm             |
| Adjustable range of safety toe          | 3 x                |
| Loading height using top plate          | 325 mm             |
| Overall dimensions (L x W x H)          | 425 x 326 x 325 mm |
| Tare weight in kg with oil fill         | 72 kg              |

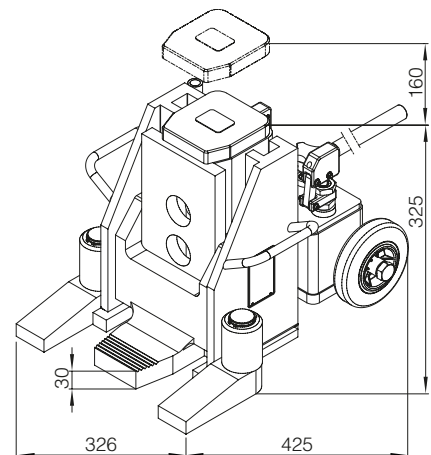

Contents

Hydraulic  
Toe Jacks

Pumps

Transport Trolleys

Rotating Trolleys

Transport Module  
ROBOT

Wheels

Special  
Transport Trolleys

Repair  
Services



## Toe Jack V5-EX ►► For heavy loads up to 5 tons

### Features:

- For difficult to access spaces and where a safety distance is required
- Up to two hydraulic jacks can be operated with the hand pump PV or (up to four jacks) with the electric pump PE
- only for use with an external pump

### Technical data

|   | V5-EX              |
|---|--------------------|
| Item number                             | 10185              |
| Full load capacity                      | 50 kN (5 t)        |
| Working pressure                        | 520 bar            |
| Minimum loading height using safety toe | 15 mm              |
| Lifting height                          | 140 mm             |
| Adjustable range of safety toe          | 3 x                |
| Loading height using top plate          | 252 mm             |
| Overall dimensions (L x W x H)          | 227 x 212 x 252 mm |
| Tare weight in kg                       | 17 kg              |

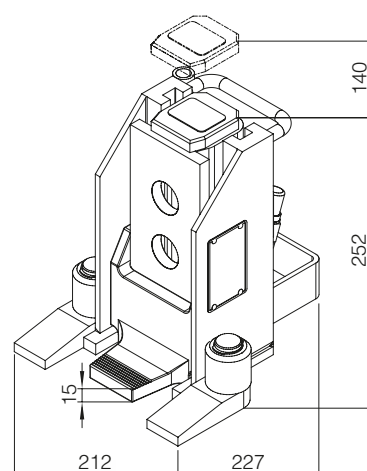



## Toe Jack V10-EX ►► For heavy loads up to 10 tons

### Features:

- For difficult to access spaces and where a safety distance is required
- Up to two hydraulic jacks can be operated with the hand pump PV or (up to four jacks) with the electric pump PE
- only for use with an external pump

### Technical data

#### V10-EX

|   |                    |
|---|--------------------|
| Item number                             | 10186              |
| Full load capacity                      | 100kN (10 t)       |
| Working pressure                        | 520 bar            |
| Minimum loading height using safety toe | 20 mm              |
| Lifting height                          | 160 mm             |
| Adjustable range of safety toe          | 4 x                |
| Loading height using top plate          | 310 mm             |
| Overall dimensions (L x W x H)          | 280 x 237 x 310 mm |
| Tare weight in kg                       | 27 kg              |

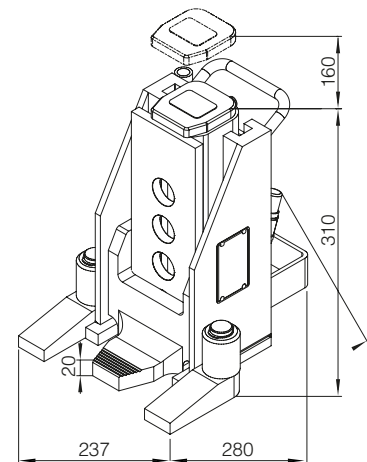

Contents

Hydraulic  
Toe Jacks

Pumps

Transport Trolleys

Rotating Trolleys

Transport Module  
ROBOT

Wheels

Special  
Transport Trolleys

Repair  
Services





## Toe Jack V30-EX ►► For heavy loads up to 30 tons

### Features:

- For difficult to access spaces and where a safety distance is required
- Operated with the hand pump PV (one jack) or with the electric pump PE (up to two jacks)
- only for use with an external pump

### Technical data

|   | V30-EX             |
|---|--------------------|
| Item number                             | 11140              |
| Full load capacity                      | 300 kN (30 t)      |
| Minimum loading height using safety toe | 40 mm              |
| Working pressure                        | 430 bar            |
| Lifting height                          | 156 mm             |
| Adjustable range of safety toe          | 2 x                |
| Loading height using top plate          | 330 mm             |
| Overall dimensions (L x W x H)          | 454 x 400 x 330 mm |
| Tare weight in kg                       | 105 kg             |

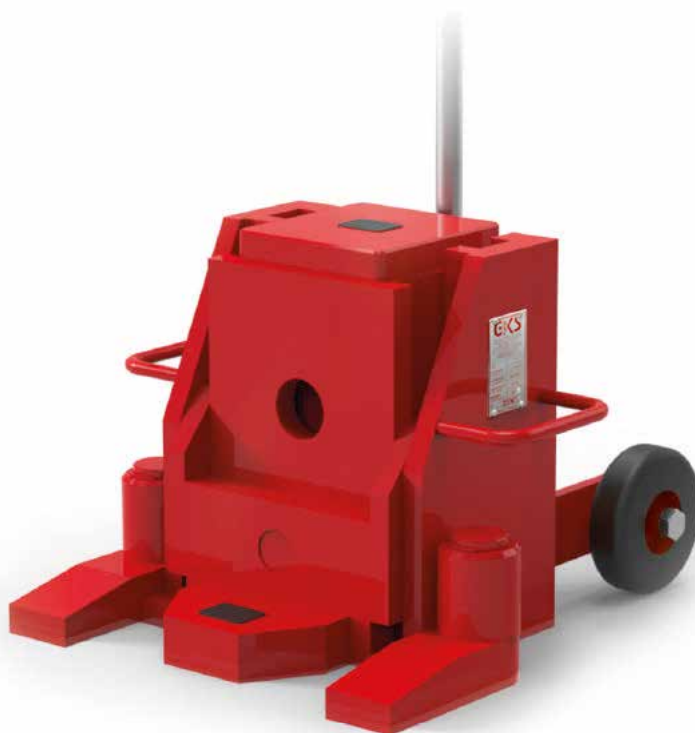
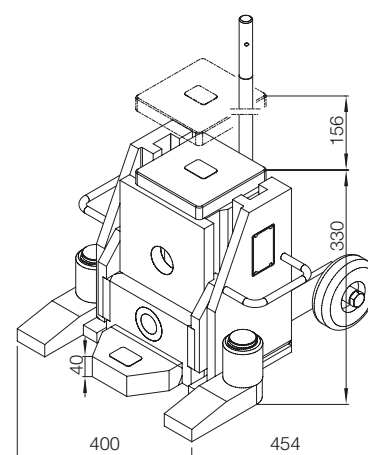



## Toe Jack V5K-EX ►► For heavy loads up to 5 tons

### Features:

- Low build with solid feet on both sides
- Up to two hydraulic jacks can be operated with the hand pump PV or (up to four jacks) with the electric pump PE
- only for use with an external pump

### Technical data

#### V5K-EX

|  |                    |
|--|--------------------|
| Item number                              | 10187              |
| Full load capacity                       | 50 kN (5 t)        |
| Working pressure                         | 520 bar            |
| Minimum loading height using safety toe  | 15 mm              |
| Lifting height                           | 105 mm             |
| Maximum lifting height for toe 1 / toe 2 | 120 / 220 mm       |
| Loading height using top plate           | 190 mm             |
| Overall dimensions (L x W x H)           | 210 x 215 x 190 mm |
| Tare weight in kg                        | 12 kg              |

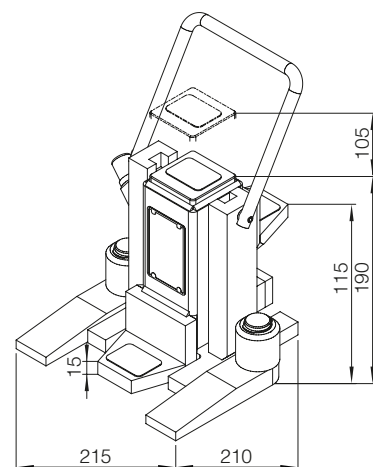

Contents

Hydraulic  
Toe Jacks

Pumps

Transport Trolleys

Rotating Trolleys

Transport Module  
ROBOT

Wheels

Special  
Transport Trolleys

Repair  
Services



## Toe Jack V10K-EX ►► For heavy loads up to 10 tons

### Features:

- Low build with solid feet on both sides
- Up to two hydraulic jacks can be operated with the hand pump PV or (up to four jacks) with the electric pump PE
- only for use with an external pump

### Technical data

#### V10K-EX

|  |                    |
|--|--------------------|
| Item number                              | 11889              |
| Full load capacity                       | 100kN (10 t)       |
| Working pressure                         | 520 bar            |
| Minimum loading height using safety toe  | 20 mm              |
| Lifting height                           | 110 mm             |
| Maximum lifting height for toe 1 / toe 2 | 130 / 220 mm       |
| Loading height using top plate           | 210 mm             |
| Overall dimensions (L x W x H)           | 260 x 287 x 210 mm |
| Tare weight in kg                        | 24 kg              |

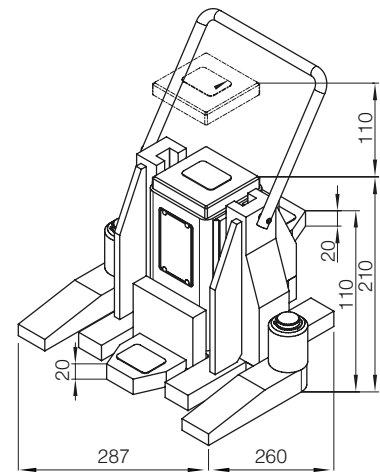



## Toe Jack V5KK-EX ►► For heavy loads up to 5 tons

### Features:

- Extremely low build for enclosed machines
- Compact dimensions, low design, low weight but 50 kN full-load capacity. This toe jack is ideal for low-built machines with sheet metal enclosures.
- Even difficult to access spaces can be met with a hydraulic hose, quick-release coupling and a model PV-K hand pump. Up to two jacks can be connected.
- This jack is your first choice if workplace safety is of utmost importance and the load must be lifted from the distance.
- Using a screwed guideways design diminishes wear and the components are easy to replace
- only for use with an external pump

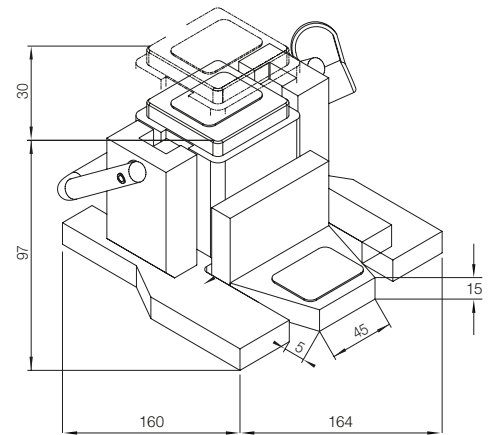

### Technical data

#### V5KK-EX

|   |                   |
|---|-------------------|
| Item number                             | 13701             |
| Full load capacity                      | 50 kN (5 t)       |
| Working pressure                        | 520 bar           |
| Minimum loading height using safety toe | 15 mm             |
| Lifting height                          | 30 mm             |
| Loading height using top plate          | 97 mm             |
| Overall dimensions (L x W x H)          | 160 x 164 x 97 mm |
| Tare weight in kg                       | 7 kg              |



Contents

Hydraulic  
Toe Jacks

Pumps

Transport Trolleys

Rotating Trolleys

Transport Module  
ROBOT

Wheels

Special  
Transport Trolleys

Repair  
Services



## Toe Jack G5 ►► For heavy loads up to 5 tons

### Features:

- Specially designed for maintenance purposes on fork lift trucks and other industrial vehicles
- Outstanding stability due to solid feet and an extended grooved safety toe

### Technical data

|   | G5                 |
|---|--------------------|
| Item number                             | 10189              |
| Full load capacity                      | 50 kN (5 t)        |
| Working pressure                        | 520 bar            |
| Minimum loading height using safety toe | 30 mm              |
| Lifting height                          | 140 mm             |
| Adjustable range of safety toe          | 3 x                |
| Loading height using top plate          | 265 mm             |
| Overall dimensions (L x W x H)          | 397 x 255 x 265 mm |
| Tare weight in kg with oil fill         | 30 kg              |

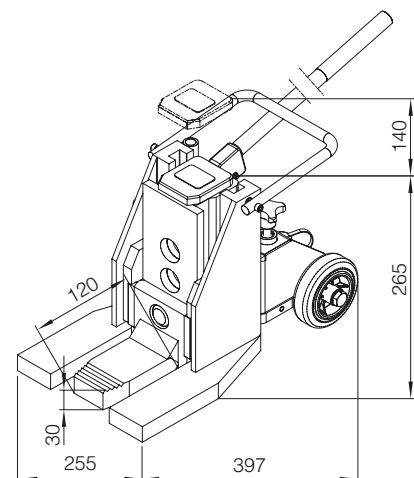





## Toe Jack G10 ►► For heavy loads up to 10 tons

### Features:

- Specially designed for maintenance purposes on fork lift trucks and other industrial vehicles
- Outstanding stability due to solid feet and an extended grooved safety toe

### Technical data

|   | G10                |
|---|--------------------|
| Item number                             | 12378              |
| Full load capacity                      | 100 kN (10 t)      |
| Working pressure                        | 520 bar            |
| Minimum loading height using safety toe | 30 mm              |
| Lifting height                          | 140 mm             |
| Adjustable range of safety toe          | 3 x                |
| Loading height using top plate          | 318 mm             |
| Overall dimensions (L x W x H)          | 461 x 280 x 318 mm |
| Tare weight in kg with oil fill         | 57 kg              |

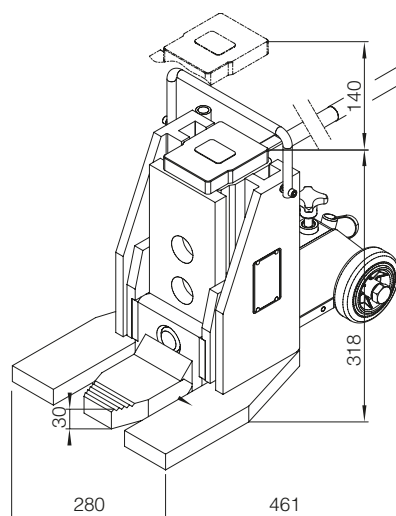

Contents

Hydraulic  
Toe Jacks

Pumps

Transport Trolleys

Rotating Trolleys

Transport Module  
ROBOT

Wheels

Special  
Transport Trolleys

Repair  
Services



## Unilifter U6 ►► For heavy loads up to 6 tons

### Features:

- An all-purpose toe jack for horizontal and vertical use

### Technical data

|   | U6                 |
|---|--------------------|
| Item number                             | 13292              |
| Full load capacity                      | 60 kN (6 t)        |
| Working pressure                        | 720 bar            |
| Minimum loading height using safety toe | 18 mm              |
| Lifting height                          | 115 mm             |
| Loading height using top plate          | 265 mm             |
| Overall dimensions (L x W x H)          | 306 x 146 x 265 mm |
| Tare weight in kg with oil fill         | 15 kg              |

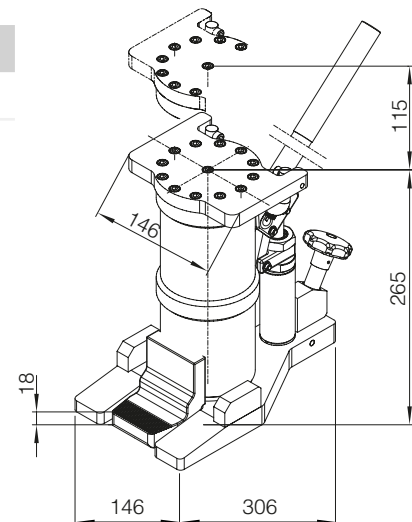



## Synchronous lifting device Quadro 60 ►► For heavy loads up to 60 tons

### Features:

- The synchronous lifting device secures synchronous lifting or lowering of loads regardless of weight distribution. It has been designed specifically for four of our standard toe jacks, max. models V15 / V15EX, which results in a total lifting capacity of up to 60 t.
- The toe jacks can be set to the desired positions individually from the control panel, in case of differing loading heights, and then be raised synchronously.
- The operation is carried out via an electric pump with remote control.
- The toe jacks are connected via 8 m long hoses, which are stored on four hose reels, equipped with an automatic retraction system.
- The system includes a heavy-duty trolley.



Contents

Hydraulic  
Toe Jacks

Pumps

Transport Trolleys

Rotating Trolleys

Transport Module  
ROBOT

Wheels

Special  
Transport Trolleys

Repair  
Services

### Technical data

### Quadro 60

|                                     |   |
|-------------------------------------|---|
| Item number                         | 13826 *   |
| Max. load capacity                  | 600 kN (60 t) **                                      |
| Working pressure                    | 520 bar   |
| Compatible with four toe jacks each | For GKS toe jacks<br>V5 to V15 and V5-EX<br>to V15-EX |
| Hydraulic unit                      | Electric pump PE ***                                  |
| Dimensions (L x W x H)              | 2000 x 800 x<br>1480 mm                               |
| Hose connection                     | 4 x 8 m ****  |
| Total weight                        | 400 kg *****  |



\* Toe jacks are not included with the supply

\*\* Depending on the size of the toe jack

\*\*\* Other pump sizes are possible

\*\*\*\* Custom lengths available on request, depending on hose connection, coupling + quick-release fastener

\*\*\*\*\* Depending on accessories / toe jacks